



7 Tarragon Drive

Guildford, GU2 9GP

£2,100 Per Calendar Month

A substantial 2 double bedroom semi detached home, offering well balanced accommodation the property offers a front aspect lounge with a full width kitchen diner overlooking the south facing garden. To the first floor there are 2 generous bedrooms, and a 4 piece family bathroom.

Other benefits include the solar panels which we are advised supply most of the energy used within the home, off road parking for 2 cars, garage with workshop behind, home office within the garden and gas central heating.

The house is positioned well for local amenities and access to bus routes, the A3, Guildford and much more!

Available

Viewing

Please contact our Fosters Lettings Office on 01252 344333 if you wish to arrange a viewing appointment for this property or require further information.

- 2 Bedroom
- Large Rear Enclosed Garden With Patio
- Gas Central Heating/Solar panels
- Large Kitchen/Dining Room
- Off Road Parking
- Garage
- Available Mid August
- 5 Weeks' Deposit £2423.07
- Council Tax Band D
- EPC Energy Rating Band (b) 88



2



1



1



B

Floor Plan

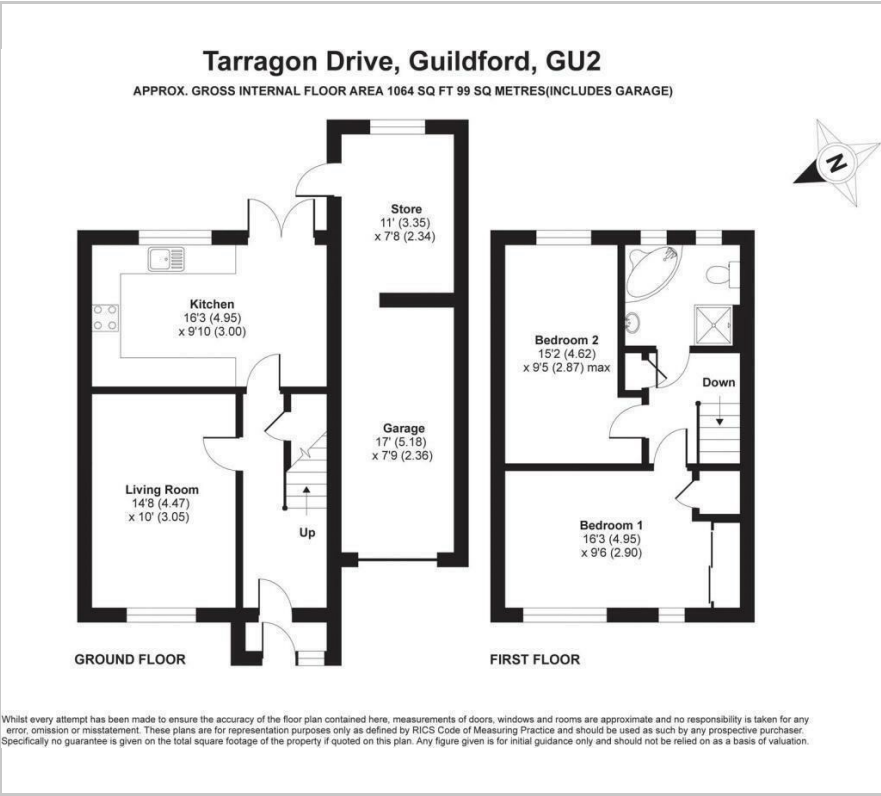

Area Map



Energy Efficiency Graph

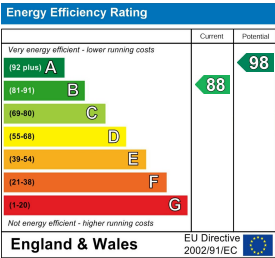

These particulars, whilst believed to be accurate are set out as a general outline only for guidance and do not constitute any part of an offer or contract. Intending purchasers should not rely on them as statements of representation of fact, but must satisfy themselves by inspection or otherwise as to their accuracy. No person in this firms employment has the authority to make or give any representation or warranty in respect of the property.